

REVISIONS AND ISSUANCE		
NO.	DATE	DESCRIPTION
08/13/2018	PRICING	
08/31/2018	ISSUE FOR PERMIT	

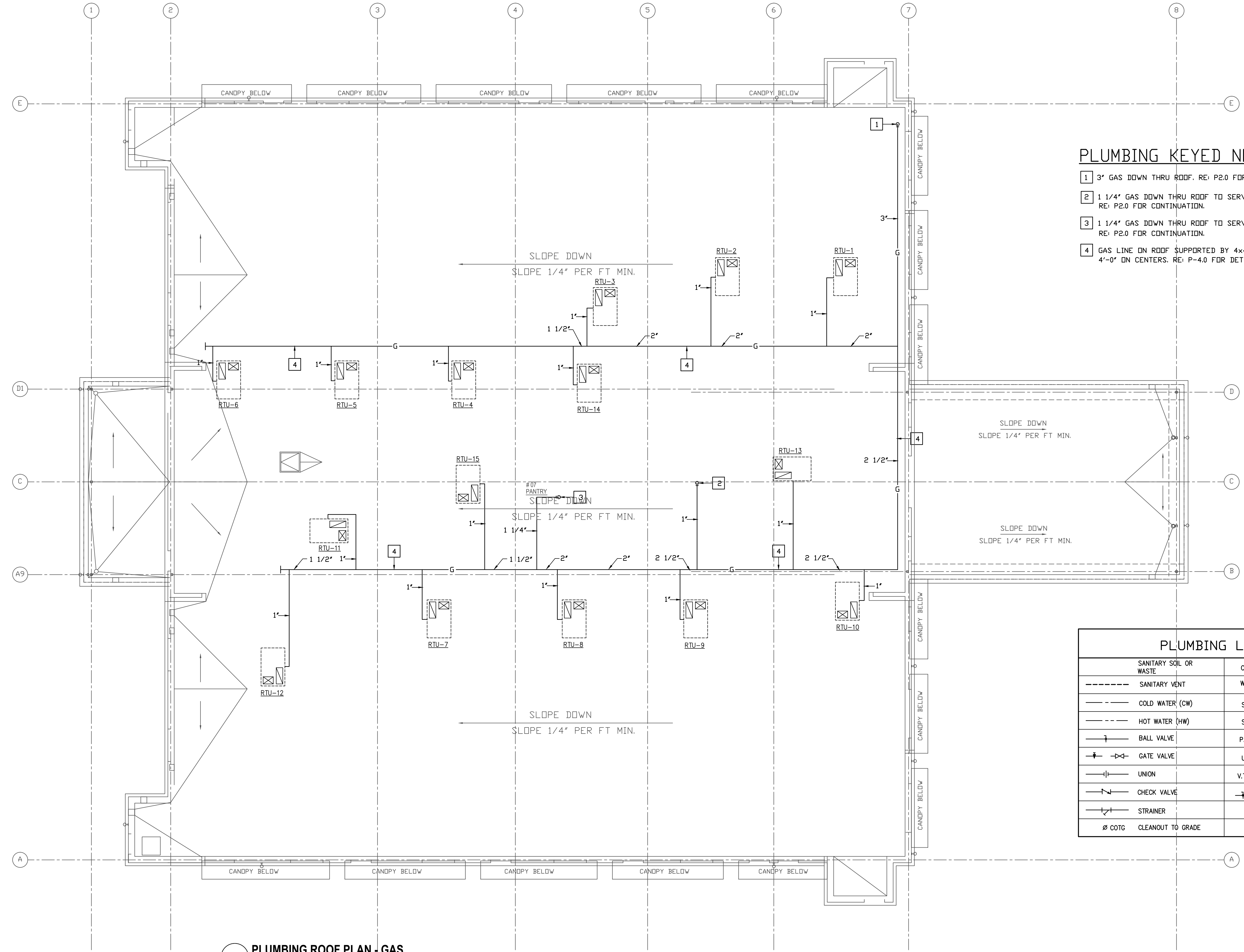

PLUMBING KEYED NOTES:

- 1 3" GAS DOWN THRU ROOF. RE: P2.0 FOR CONTINUATION.
- 2 1 1/4" GAS DOWN THRU ROOF TO SERVE WATER HEATER. RE: P2.0 FOR CONTINUATION.
- 3 1 1/4" GAS DOWN THRU ROOF TO SERVE RANGE/OVEN. RE: P2.0 FOR CONTINUATION.
- 4 GAS LINE ON ROOF SUPPORTED BY 4x4 REDWOOD BLOCKS 4'-0" ON CENTERS. RE: P-4.0 FOR DETAIL.

PLUMBING LEGEND		
	SANITARY SOIL OR WASTE	C.O. CLEAN OUT
	SANITARY VENT	W.H. WALL HYDRANT
	COLD WATER (CW)	S.P. SPRINKLER PIPE
	HOT WATER (HW)	S.S. SUB SURFACE DRAINAGE
	BALL VALVE	P.I.V. POST INDICATOR VALVE
	GATE VALVE	U.H. UNIT HEATER
	UNION	V.T.R. VENT THRU ROOF
	CHECK VALVE	PRESSURE GAUGE W/ GAUGE COCK
	STRAINER	
	Ø COTG CLEANOUT TO GRADE	

1 PLUMBING ROOF PLAN - GAS
1/8" = 1'-0"

IVY KIDS EARLY LEARNING CENTER
 4434 CR 94
 Manvel, Tx 77578

MEP Consultants
 BLK Engineering & Consulting Co.
 3423 Spring Arbor Ln.
 Sugar Land, TX 77479
 (t) 832 563 3127
 TBPE Firm #12672



DRAWING TITLE	
PLUMBING ROOF PLAN - GAS	
DRAWN BY	CHECKED BY
FK	CK
DATE	JOB NO.
03/30/2017	sedona lakes
DRAWING NO.	
P-3.0	